

Field unit for 1 fire damper

- connects 1 fire damper to the Bustec Ringbus
- provides a plug connection for the Belimo BF24..-ST, BFG24..-ST and BLF24..-ST actuators
- has a predefined address (no addressing required during system commissioning)
- AC 230 V mains power



## Technical data

Electrical data	Nominal voltage	AC 230 V 50/60 Hz
	Nominal voltage range	AC 100 ... 230 V
	For wire sizing	18 VA
	Power consumption from mains	Actuator consumption + 200 mW
	Power consumption from bus	5 mW
	Connecting	Power supply terminal 2 x 3 x max. 2.5 mm <sup>2</sup> (min. 0.5 mm <sup>2</sup> ) Actuator outputs Plug, 6 poles Actuator power supply Plug, 3 poles 2 x RingBus terminal 4 x 1.5 mm <sup>2</sup> wire
Safety	Protection class	Class II (all insulated)
	Degree of protection	IP54
	EMC	CE according to 2004/108/EC
	Low-voltage-directive	CE according to 2006/95/EC
	Ambient humidity range	IEC 60730-1 max. 95 %
	Ambient temperature range	-20 ... +60°C
Dimensions / weight	Non-operating temperature	-40 ... +85°C
	Maintenance	Maintenance-free
	Dimensions	154 x 114 x 77 mm
	Weight	400 g

## Safety notes



- The device is not allowed to be used outside the specified field of application, especially in aircraft or in any other airborne means of transport.
- Caution: Power supply voltage!
- It may only be installed by suitably trained personnel. Any legal regulations or regulations issued by authorities must be observed during assembly.
- The device may only be opened at the manufacturer's site. It does not contain any parts that can be replaced or repaired by the user.
- The device contains electrical and electronic components and is not allowed to be disposed of as household refuse. All locally valid regulations and requirements must be observed.

## Product features

Control of one fire damper actuator	RBFU 1.01 ST is used for controlling one Belimo 24 V fire damper actuator (BF24..-ST, BFG24..-ST, BLF24..-ST). The unit is connected to the ringbus master controller module via a 4 wire ring bus communication.
Connection	The Belimo ST actuators are equipped with plug connectors that can be plugged directly into RBFU 1.01 ST unit.
Isolation	The actuator is isolated from mains by a transformer.
Predefined address	Each unit has a predefined address and therefore has not to be addressed during the system commissioning.
Work without 230 V	RBFU 1.01 ST unit is able to work without 230 V, but then it is only sending data about actuator position to Ringbus master controller and is not able to turn on/off the actuators.

## Electrical installation

Wiring diagram

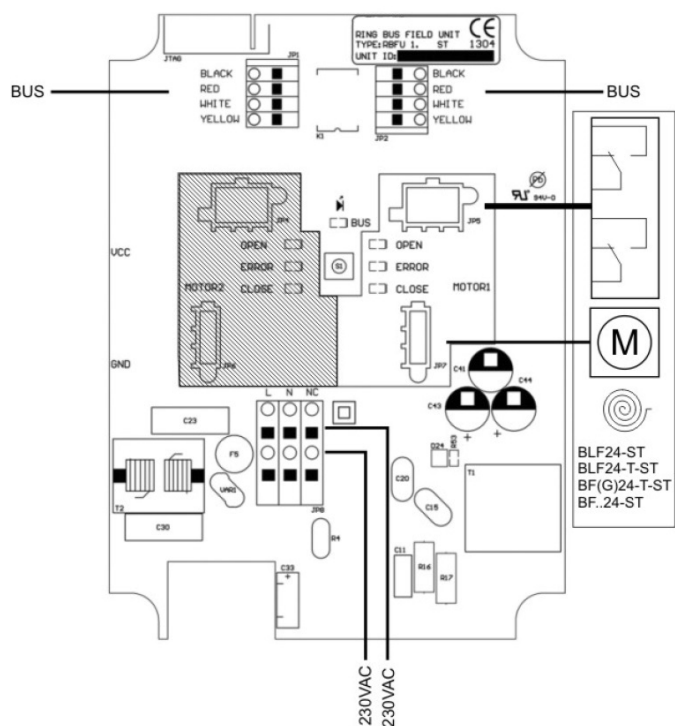

## Dimensions [mm]

Dimensional diagrams

